

Home Remodel Design Specification



July 21, 2018

Rich & Alyssa Trow

Exterior Front



New 6' x 18.5' covered front porch with white craftsman columns

Front door: Craftsman single fiberglass door with 2 sidelights, in Walnut
same size and location as current door

Garage doors: C.H.I. Accents Woodtones Steel doors, 9' x 7'
Stamped Carriage Short in Walnut, with Madison windows

Exterior Finishes: dark gray wood horizontal siding
light gray wood vertical siding on gable ends
dark gray paint on bricks
white soffits, fascia, trim, corners, & shutters

Rich & Alyssa Trow

Exterior Back



New 14' x 17.5' sunroom on footings

New 17.5' x 19.5' deck with black aluminum railings

Deck door: Replace patio door with 32" full glass single door

Replace bay window with smaller window

- Will be over kitchen sink
- Centered between sunroom and deck door

Rich & Alyssa Trow

Interior Layout & Dimensions

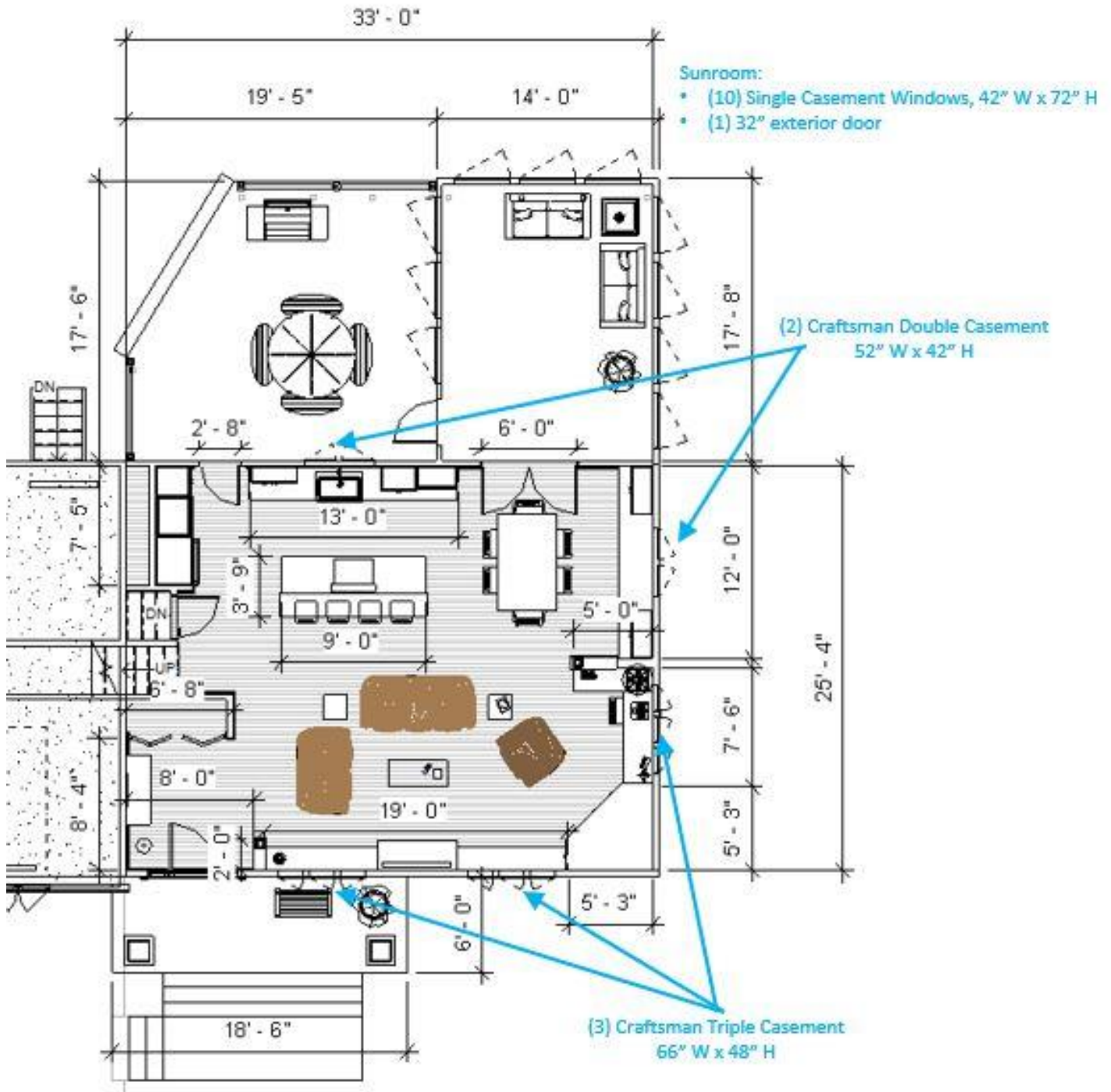

Kitchen & Dining Area



Finishes

- White cabinets, black granite, gray stone backsplash, satin nickel pulls
- Dark wood floors
- Light gray painted walls
- White trim, doors, and crown molding
- Satin nickel hinges and door handles

Island

- 9' wide x 27" deep for stovetop and downdraft ventilation
- 42" high seating area with side walls and shiplap

Refrigerator, double-oven, and 22" wide pantry where old fireplace exists

- All brick needs to be removed

Doors & Windows

- Patio door replaced with 32" full glass door
- Bay window replaced with smaller window over sink
- Current kitchen window replaced with double full glass French doors to sunroom

Rich & Alyssa Trow

Kitchen Sink Area Cabinets

Total width: 13'



Pull-out Garbage

Window

- Craftsman double casement 52" W x 42" H

Rich & Alyssa Trow

Island Cabinets

Total width: 9' (Cabinets 27" deep)



Downdraft Ventilation Up



Rich & Alyssa Trow

Refrigerator, Double Oven, and Pantry Cabinets

Total width: 7' 5"



Rich & Alyssa Trow

Dining Area Cabinets

Total width: 12'



Window

- Craftsman double casement 52" W x 42" H

Rich & Alyssa Trow

TV Area, Fireplace, and Desk



Finishes

- Dark stained cherry cabinets, bronze pulls
- Dark wood floors
- Light gray painted walls
- White trim and crown molding

Gas fireplace with custom corner cabinet and mantel

Built-in desk area

Windows

- Replace current dining room windows and bay window with matching craftsman windows

Rich & Alyssa Trow

Desk Cabinets



Dimensions

- Seating area: 30" W x 30" H
- Filing drawers and printer drawer cabinets: 21" W x 21" D
- Three drawer cabinet: 24" W x 16.5" D
- Total area: 5' x 7.5'

Window

- Craftsman triple casement 66" W x 48" H

Rich & Alyssa Trow

Under TV Cabinets

Total width: 19'



Dimensions

- Lower cabinets: 30" H x 16" D
- Taller cabinets: 36" H x 21" D

Window

- Craftsman triple casement 66" W x 48" H

Gas Fireplace Woodwork

Height: 4' 3"

Width of Front: 4' 8"



Rich & Alyssa Trow

Entry Area



Finishes

- Light gray painted walls
- White trim and crown molding
- Satin nickel hinges and door handles

Coat closet – 80" W (rotated from existing position)

Doors

- 36" Craftsman single fiberglass entry door with 2 sidelights, white (or walnut)
- 6-panel bi-fold closet doors

Rich & Alyssa Trow

Sunroom



Finishes

- Light gray painted walls
- Satin nickel hinges and door handles
- Gray wood-look tile, with in-floor heating
- Ceiling fan

Doors & Windows

- 32" exterior door with full glass
- Single casement windows, 42" W x 72" H

Rich & Alyssa Trow